

Stair Stringer Details

G1 Stair Stringer - Top Support - Ledger

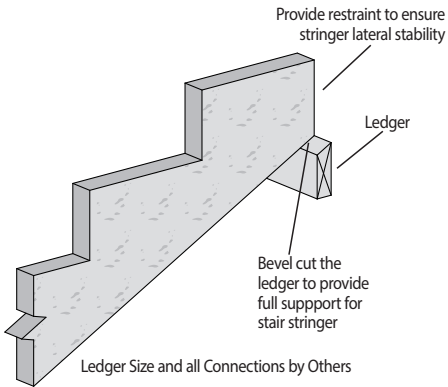

G2 Stair Stringer - Top Support - Connector

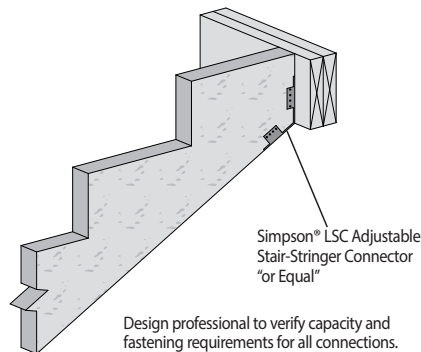

G3 Stair Stringer - Bottom Support - Concrete

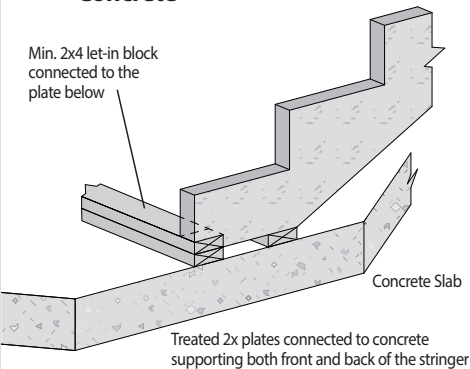

G4 Stair Stringer - Bottom Support - Beam

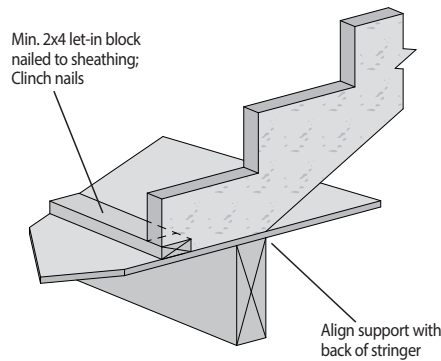

G5 Stair Stringer - Bottom Support - Ledger

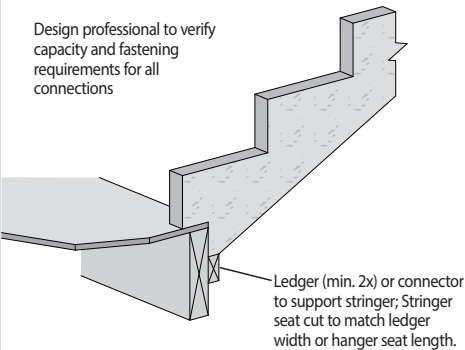

Customer Service and Product Technical Support: 1.888.820.0325

E-mail: customer.support@lpcorp.com.

Visit our web site at: www.lpcorp.com.

LP SolidStart Material Safety Data Sheets (MSDS) may be found on our website, www.lpcorp.com.

LP SolidStart Engineered Wood Products are manufactured at different locations in the United States and Canada. Please verify availability with the LP SolidStart Engineered Wood Products distributor in your area before specifying these products.

Cal. Prop 65 Warning:

WARNING: Drilling, sawing, sanding or machining wood products can expose you to wood dust, a substance known to the State of California to cause cancer. Avoid inhaling wood dust or use a dust mask or other safeguards for personal protection. For more information go to www.P65Warnings.ca.gov/wood.



PEFC®
29-31-102



Good for you. Good for our forests.
www.sfi-program.org
SFI-00000

BV-SFICOC-US09000262

© 2019 Louisiana-Pacific Corporation. All rights reserved. APA and APA Rated are registered trademarks of APA – The Engineered Wood Association. FastenMaster® and TrussLok® are trademarks of OMG, Inc., SIMPSON Strong-Tie® is a registered trademark of Simpson Strong-Tie Company, Inc., USP® is a registered trademark of MiTek Holdings, Inc., SFI and the associated logo are trademarks of Sustainable Forestry Initiative, Inc., PEFC and the associated logo are trademarks of Programme for the Endorsement of Forest Certification, LP® and SolidStart® are registered trademarks of Louisiana-Pacific Corporation. Printed in USA. Specifications (details) subject to change without notice.

NOTE: Louisiana-Pacific Corporation periodically updates and revises its product information. To verify that this version is current, contact the nearest sales office, visit LPCorp.com, or call 1-888-820-0325.

LPEW0456 5/19 ARGENT

Warnings

The following conditions are NOT permitted!

Do not use visually damaged products without first checking with your local LP SolidStart Engineered Wood Products distributor or sales office.

LP SolidStart LVL & LSL Details

P1 Top Loaded Beam - Nailed Connection

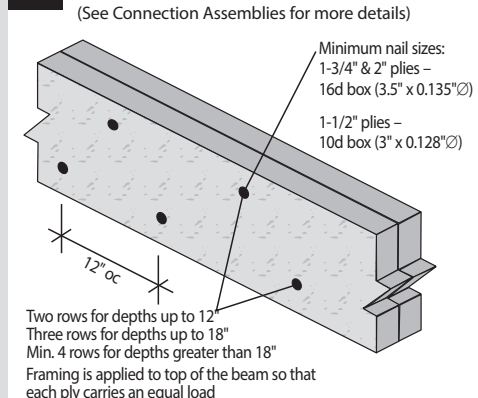

P2 Top Loaded Beam - Bolted Connection

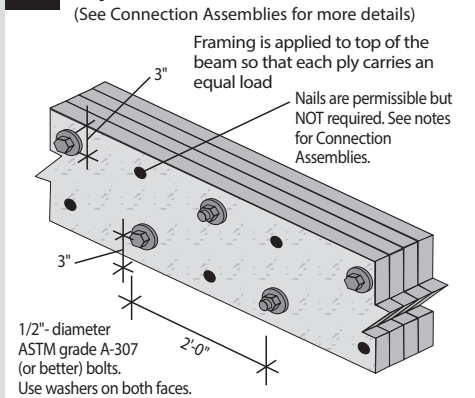

P3 Beam Connection

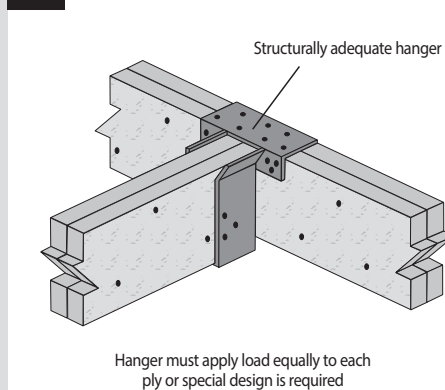

P4 Steel Column & Wood Column

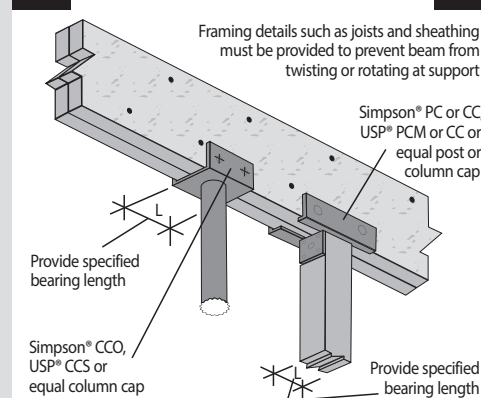

P6 Side Loaded Beam

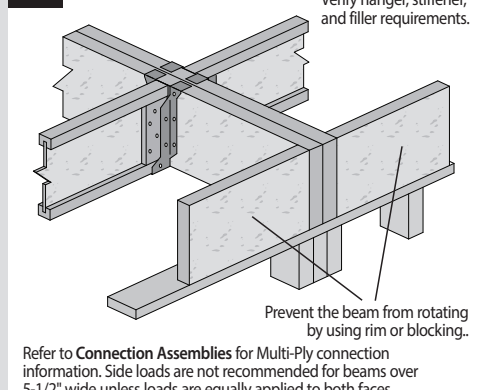

P7 Concrete Wall

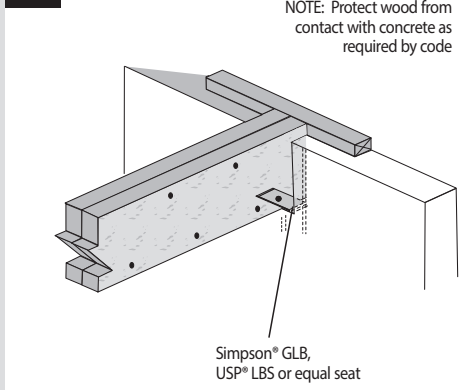

Q1 Window/Door Header

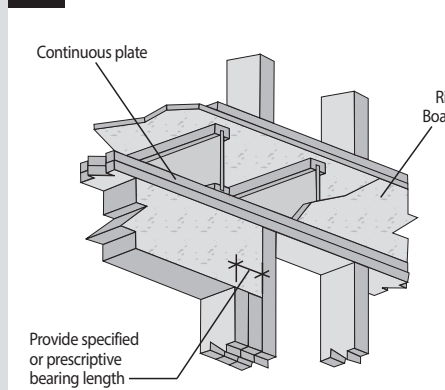

Q4 Masonry Hanger

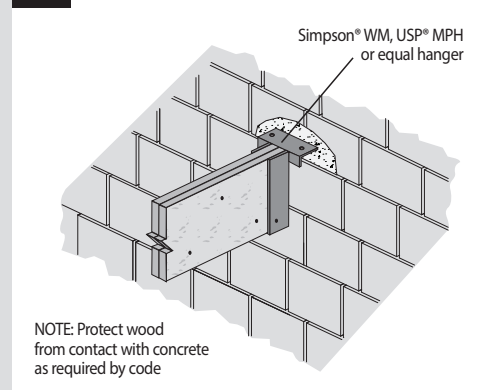

CONNECTION ASSEMBLIES

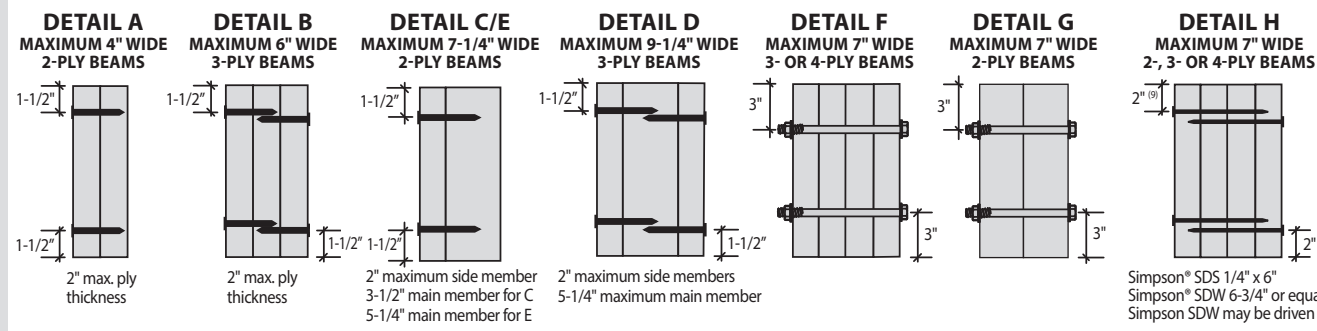

NOTES:

1. Use 2 rows of nails for depths to 12". Use 3 rows of nails for depths greater than 12", up to 18". Use 4 rows of nails for depths greater than 18", up to 24".
2. 16d box (3-1/2" x 0.135") or common (3-1/2" x 0.162") nails shall be used for 1-3/4" and 2" thick plies. 10d box (3" x 0.128") or common (3" x 0.148") nails shall be used for 1-1/2" thick plies. 16d sinkers (3-1/4" x 0.148") may be used for 1-3/4" and 2" plies provided the nails are driven alternating from each face (see note 3).
3. For detail A or when attaching the first two plies for details B and F (optional), the nails may be driven all from one face or alternating from both faces. If the nails do not fully penetrate the second ply, then the nails shall be driven from both faces.
4. When driving nails from each face, alternate every other nail in each row.
5. For detail C/E, when side-loaded, the larger side-load shall be applied to the thicker ply (main member).
6. For details F and H, it is permissible to nail the plies together before bolting or driving Simpson SDS or SDW (or equal) screws. Nail two plies together then nail one additional ply to each side.
7. Beams wider than 5-1/2" shall be top-loaded or side-loaded from both sides to prevent rotation. Consult a professional engineer for other options.
8. Other nail, screw or bolt configurations are possible. Contact your LP SolidStart Engineered Wood Products distributor.
9. Minimum of 2" or the screw mfg's edge distance.

R9

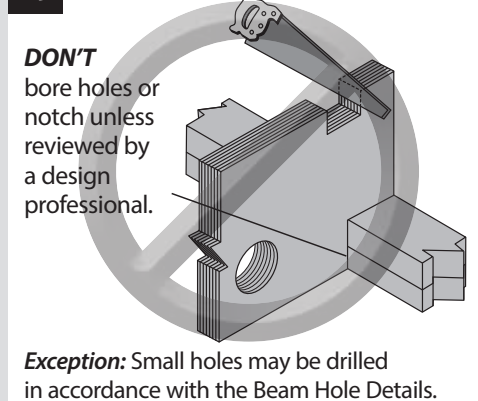

R10 DON'T Overcut Stair Stringers

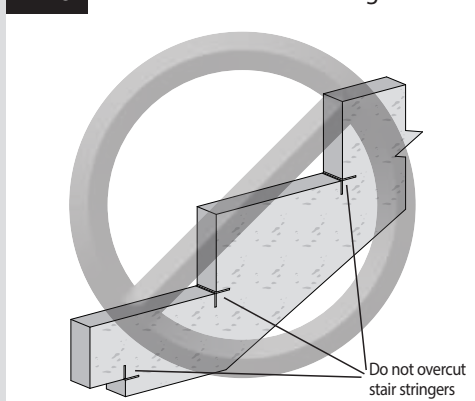

R11 DON'T Partially Support Stringers - Top

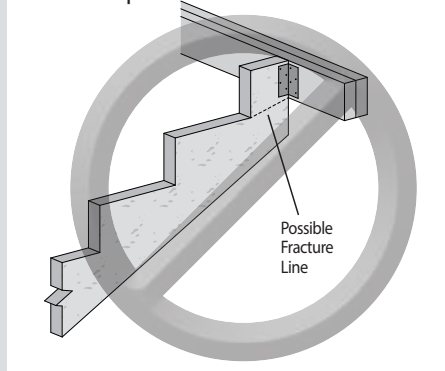

R12 DON'T Partially Support Stringers - Bottom

